

SECOND FLOOR TRUSSES
SYSTEM BY OTHERS
(SEE SPEC SHEET)

GENERAL FRAMING NOTES

MANUFACTURER TO DETERMINE THE SIZE AND SPECIFICATION OF ALL LAMINATED VENEER GLUED LUGS AND ALL OTHERS. THE MANUFACTURER'S SIZE AND SPEC. SHALL SUPERSEDE THOSE SHOWN ON THESE PLANS. THE MANUFACTURER SHALL SUPPLY SPECIFICATIONS FOR ALL FRAMES FOR ENGINEERED PRODUCTS.

PROVIDE SOLID BLOCKING BELOW ALL BEAM JOIST CONTINUOUS DOWN TO SILL PLATES, COLUMNS, OR BEAMS OF FOUNDATION.

DOUBLE JOIST OR BLOCKING UNDER ALL WALLS PARALLEL TO JOIST.

MINIMUM OF ONE ROW OF PERIMETER BRIDGING, 1 X 2 OR SOLID BLOCKING PER JOIST SPAN UP TO 14'-0". USE TWO ROWS BEYOND 14'-0".

DOUBLE HEADER JOIST AND TRIMMERS AT ALL FLOOR OPENINGS WHERE JOIST TERMINATE.

ALL DOOR AND WINDOW HEADERS SHALL BE MIN. 7" X 10"

DO NOT SCALE DRAWINGS

OPENINGS TO THE EXTERIOR WALLS ARE TAKEN FROM THE OUTSIDE FACE OF THE STUD. BRACING AND BRIMS ARE NOT INCLUDED IN THE DIMENSION OR TO THE EXTERIOR FACE OF THE FOUNDATION WALL.

OPENINGS TO THE INTERIOR WALLS ARE TAKEN FROM THE EDGE OF THE STUD.

CONTRACTORS SHALL VERIFY ALL DIMENSIONS AND ARE RESPONSIBLE FOR CORRECTING AND CORRELATING THE SAME.

THE C.W. GREEN GROUP P.O. BOX 42 MONTICELLO, VA 22953 PHONE: 800.213.0868 FAX: 800.760.0722 ching@theCWgroup.com www.theCWgroup.com		UNDERMERE VILLAGE LOT 8 UNDERMERE VILLAGE ELINGTON, CT 06035 DRAWN BY: C.W. SCALE: 1/4" = 1'-0" DATE: AUGUST 3, 2005	FIRST FLOOR PLAN PAGE: 3
--	--	--	------------------------------------

**SECOND FLOOR TRUSS
SYSTEM BY OTHERS
(SEE SPEC SHEET)**

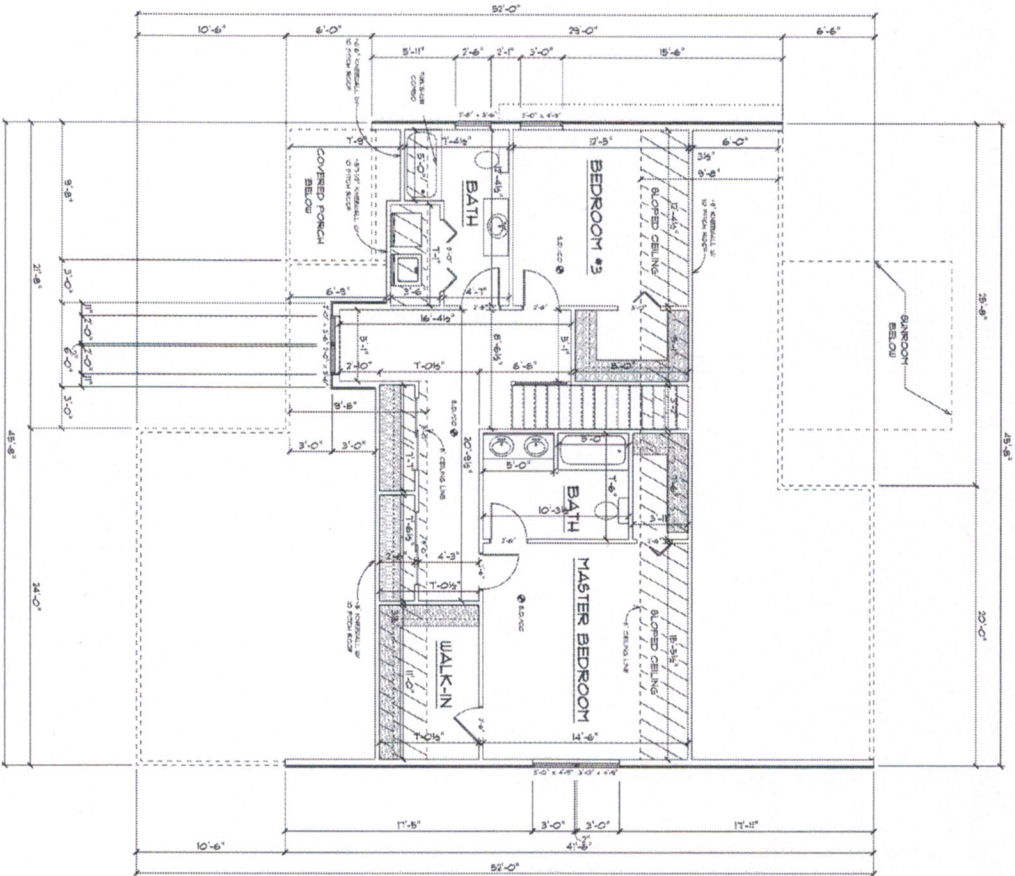

2ND FLOOR PLAN
985 SQ. FT. GROSS AREA

GENERAL FRAMING NOTES

MANUFACTURER TO DETERMINE THE SIZE AND SPECIFICATION OF ALL LAMINATED VENEER LUMBER (LVL) GABLES, JOIST, OR OTHER ENGINEERED WOOD PRODUCTS. THE MANUFACTURER'S SIZE AND SPEC. SHALL SUPERSEDE THE SIZES AND SPEC. SHOWN ON THESE PLANS. THE MANUFACTURER SHALL VERIFY THE SPECIFICATION FOR ALL BEAMS FOR ENGINEERED PRODUCTS. PROVIDE SOLID BLOCKING BELOW ALL BEAM POST CONTINUOUS DOWN TO ALL PLATE, COLUMN, OR BEAMS OF FOUNDATION. DOUBLE JOIST OR BLOCKING UNDER ALL WALLS PARALLEL TO JOIST. NUMBER OF ONE ROW OF NAIL BRIDGING 1 X 3 OR SOLID BLOCKING PER JOIST SPAN UP TO 4'-0". USE TWO ROWS BEYOND 4'-0". DOUBLE HEADER JOIST AND TRIMMERS AT ALL FLOOR OPENINGS WHERE JOIST TERMINATE. ALL DOOR AND WINDOW HEADERS SHALL BE TRIPLE 2" X 10"

DO NOT SCALE DIMENSIONS

DIMENSIONS TO THE EXTERIOR WALLS ARE TAKEN FROM THE OUTSIDE FACE OF THE STUD, SHEATHING AND SIDING ARE NOT INCLUDED IN THE DIMENSION OR TO THE EXTERIOR FACE OF THE FOUNDATION WALL. DIMENSIONS TO THE INTERIOR WALLS ARE TAKEN FROM THE EDGE OF THE STUD. CONSULTORS: SHALL VERIFY ALL DIMENSIONS AND ARE RESPONSIBLE FOR CORRECTING AND CORRELATING THE SAME.

THE C.W. GREEN GROUP

P.O. BOX 42
MONTVILLE, CT 06353
PHONE: 860.213.0486
FAX: 860.760.6722
cwg@cwgreen.com
www.cwgreen.com



UNDERMERE VILLAGE

LOT 8 UNDERMERE VILLAGE
BRANDEN CT 06033

SECOND FLOOR PLAN

DATE: AUGUST 3, 2023
SCALE: 1/4" = 1'-0"